



Yuasa Technical Data Sheet

Yuasa 6N4-2A-9 - Conventional 6 Volt Battery

Performance

Voltage	6V
Capacity (10-hour)	4Ah
Capacity (20-hour)	4.2Ah

Dimensions (±2mm)

Length	71mm
Width	71mm
Height	96mm

Weights & Measures

Mean Weight with Acid	0.8kg
Acid Volume	0.2l

Mounting Angle

Angle A	Vertical only
Angle B	Vertical only
Angle C	Vertical only

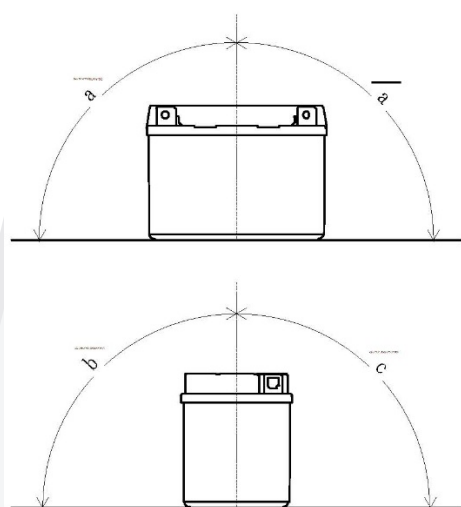

Technology

Technology

Cast Sb/Ca

Cell Assembly Layout

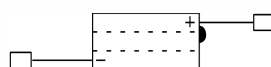

Data Sheet generated on 12/12/2016 – E&OE